

Ground Floor: Health Sciences Centre

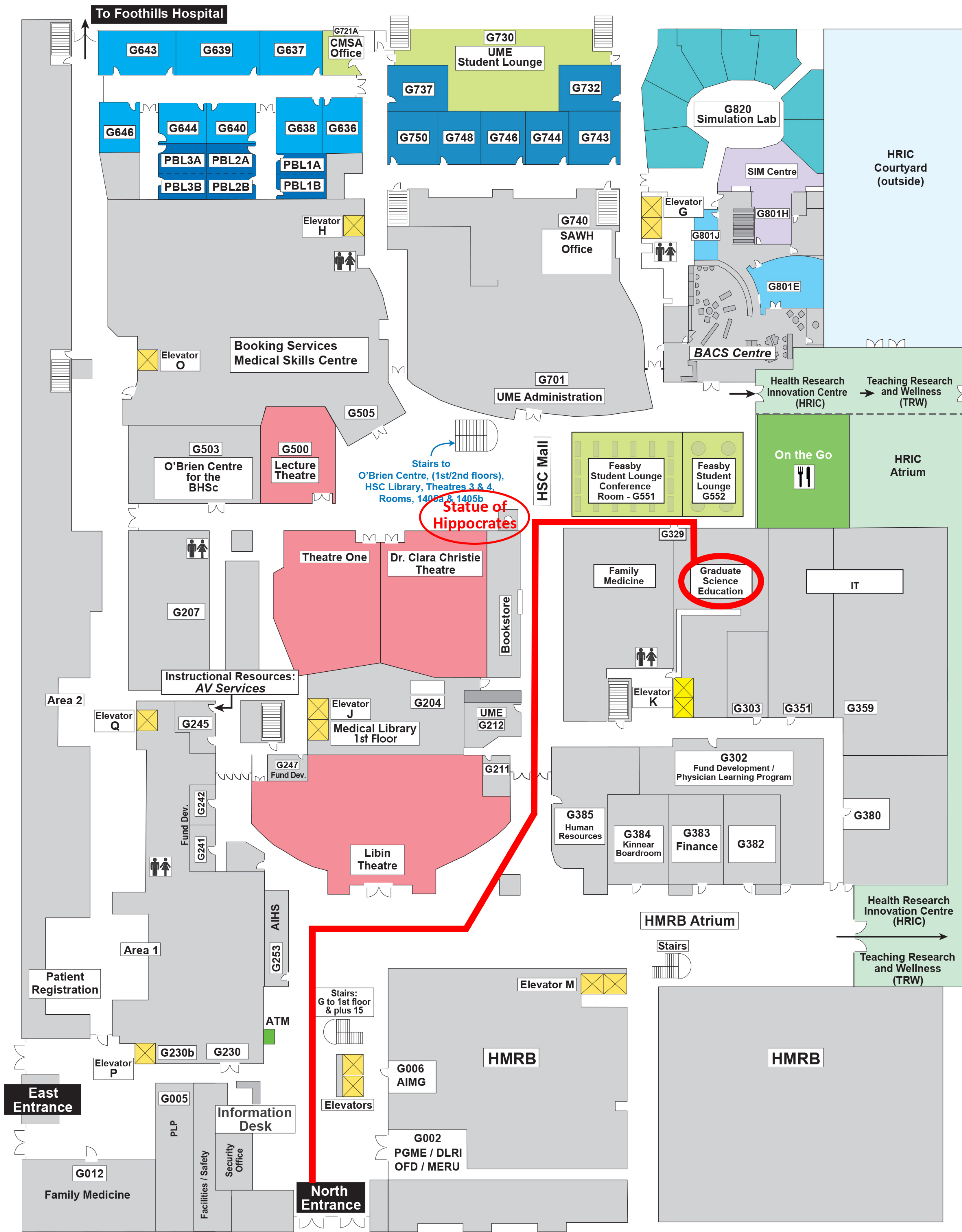

Hospital Drive

Parking Lot 6

These are the first set of doors to the Graduate Science Education (GSE) Office and can be found in the HSC Mall. Once you pass through these doors, the door straight ahead leads to the Feasby Student Lounge, and the door on the right will lead to the GSE Office.



After passing through the first set of doors, go through the next set of doors to the right as noted on the previous page. Please note the person sitting at this front desk works with with the Family Medicine Undergraduate Education Office, not the GSE Office.



The door at the end of the room and to the left leads to the GSE Office. This door is unlocked between 8:30am-12pm and 1pm-4pm each day. Please feel welcome to come in during these times (the door is fairly heavy, so it may seem locked at first even if it isn't). The light on the black panel beside the door will be green when it is unlocked.



Once you enter the GSE office space you will find a notice on the wall that will direct you to the office of the specific person you are looking for.



The Graduate Science Education office is located in the Health Sciences Centre building on the Foothills campus.

Address: 3330 Hospital Drive NW, Calgary, AB T2N 4N1

Admin Office phone #: 403.220.5712

Admin Office Room #: G341A